



Notre Dame des Missions Performing Arts Centre

Set in the grounds of Sacred Heart College in the centre of Lower Hutt, the Notre Dame des Missions Performing Arts Centre is a fully functional performance space available for in school use and also hire to the Lower Hutt community. Designed by OPUS Architects and completed in February 2013, the venue comprises an auditorium seating up to 540 people, full back-of-house and service facilities, including a caterer's kitchen and beautifully appointed foyer spaces.

It also offers a technical infrastructure in line with most commercial performance venues including theatrical lighting, audio visual and wireless internet capabilities.

1.Site

The Notre Dame des Missions Performing Arts Centre (PAC) is located in the centre of the Sacred Heart College Campus.

1.1 Floor plan:

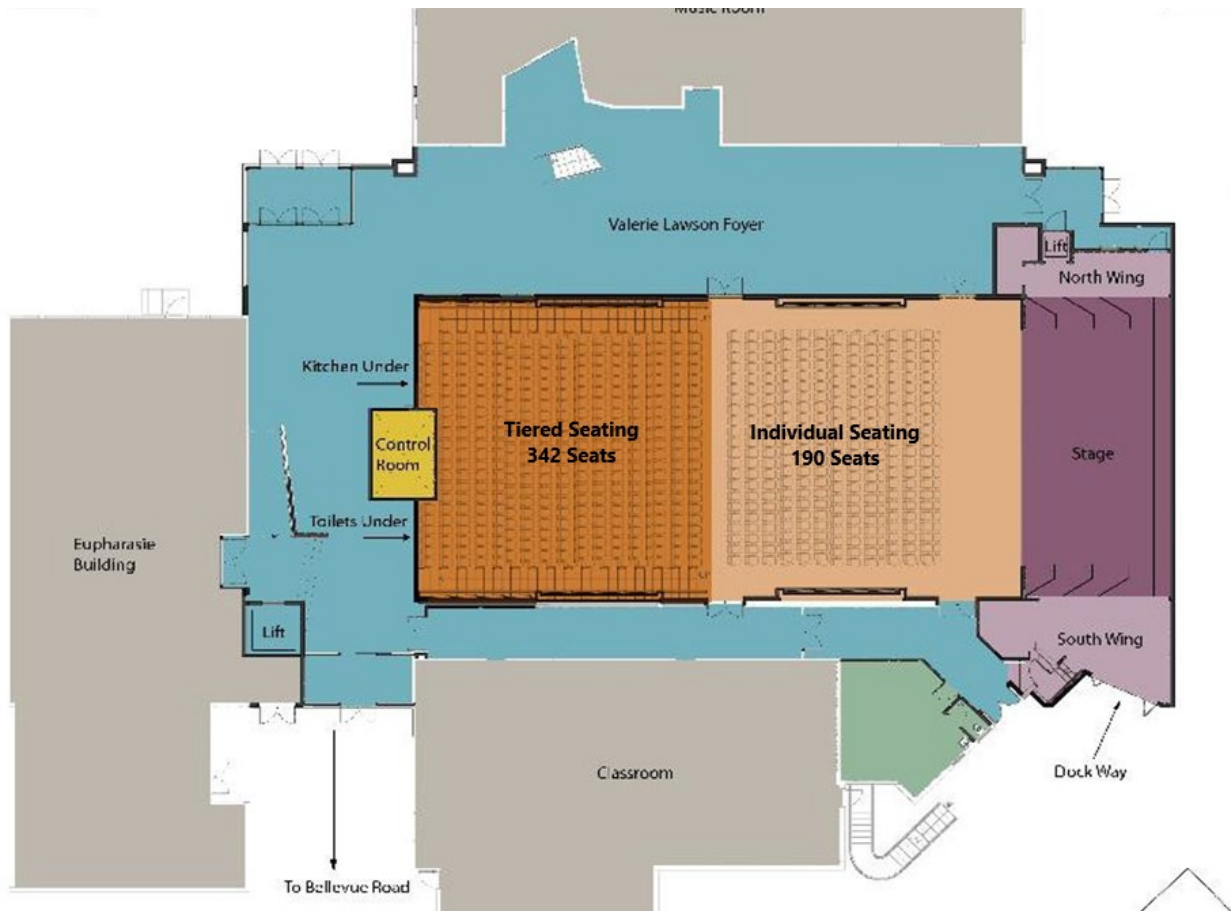

1.2 Foyer spaces:

The PAC consists of split foyer spaces on the Northern and Eastern side of the auditorium, which serve as a pre-function gathering area and are large enough to provide amenity for the provision of food/drink, or even trade show displays.

The foyer spaces are temperature controlled open plan pre-event meeting spaces & can be set up fully seated, as breakout rooms or even a café style reception area – to be set up by the hire.

The Lawson Foyer provides a fully featured caterer's kitchen and servery.

1.3 Auditorium

The PAC auditorium is a multifunctional space suitable for a range of uses and is effectively a modern, fully equipped theatre based on the classic design you would expect to find in any Opera House, but on a slightly smaller scale. This makes it very versatile for a number of uses from lecture theatre to conference presentations and full theatre and musical concert performances.

The choice of all elements installed are top quality brands known to this industry and have been chosen for the fit out with absolutely no expense spared in their design.

The general layout consists of a proscenium arch end-on stage with large wing areas to enable performers to egress both sides of stage.

A fly-floor with a winch system that consists of six separate lighting and rigging bars. These hold both pre-set theatrical woollen drape legs along with various Selecon Stage Luminaires including 8x PC 2kw floods with Barndoors, 4x Profile 2k spots, and even 10 high quality, full colour LED par-cans all flown, and all connected via way lines back to the house dimmers.

A Unistrut tab track sits one metre from the back wall still allowing talent to cross from one side to the other completely out of view behind the heavyweight woollen drape line reveal that can open and close by hand with ease from the prompt side backstage

A fully equipped technical control booth sits high up at the rear of the auditorium seating. This room houses all the mail controls for the theatre, from house lighting, to sound and stage lighting control desk. The main CAT6 Ethernet Network Patch Bay & routers for sending control data to all the various data panels is also located here making it easy to send all the control data and show content around the venue, to the Projectors, Lighting Dimmers and directly connects with the stage itself and other handy points around the venue.

The Auditorium is licenced to hold up to a maximum of 540 people.

The Auditorium Seating is comprised of two separate levels:

- Raked seating bank of 342 seats (22 seats per row)
- Individual flexible seating - Sacred Heart College can provide up to 190 chairs for the Hiree to set up in a layout that fits the nature of the hire. This seating can also be completely removed revealing a huge area for general admission concert style standing area, or whatever your need for this space may require.

The proscenium has a Matai Wood Fascia, recycled from the old SHC hall flooring timber. This compliments the acoustically engineered auditorium that also includes in its design, large

baffle panels to aid in tuning the room plus, a full hearing aid loop is also in place to provide top tier acoustic capacity.



1.4 Technical Control Room

The Technical Control Room sits high up at the rear of the auditorium. Access to the control room is via the stairs adjacent to the raked seating.

The technical control room provides the main control for all theatrical systems including House Lighting Control, Theatrical Lighting, Audio systems and the A/V & Data Projector System.

The layout is spacious and is based around a wall-to-wall solid work bench on which the Theatrelight 48 channel Scenemaster Lighting control desk and the Behringer X32 sound console sits with ample working space either side for numerous other operators or computer stations that are generally used to serve show content etc.

The view of the stage from this control room is unobstructed and allows the sliding glass windows to close and provide a more soundproof operator environment. This is a well-appointed comfortable working environment, a spacious modern control room that matches the rest of the facility.

2. Technical Infrastructure

2.1 Lighting Control

The current lighting infrastructure consists of a 'house lighting bank' and 'theatrical lighting'.

House Lighting is supplied with the room hire:

The auditorium has both fluorescent strip lights and dimmable halogen downlights controlled via the technical control room.

LED strip lighting is also installed under the handrails on either side of the raked seating block in the rear half of the auditorium. These provide more than adequate, but subtle illumination of the stairs even when the theatre is in a general black out lighting state (show-mode).

Basic Lighting Package supplied for \$100:

The stage lighting bars, waylines and dimmers provide for a maximum of 48 lamps which allow for a basic stage wash in white and specials where required. The backstage dimmer room includes a professional patch bay that plugs from the dimmers directly to the fly bars.

There is also a 400mm professional aluminium box truss spanning the full width of the stage area flown via 2x 1-Ton chain motors situated 15 meters out in front of the proscenium arch. This provides ample front lighting fixtures for the stage and has plenty of room with additional waylines and sufficient weight loading to allow many more lights or projectors when required. We have a combination of 5x 1535 1000-watt Pacific profiles and 12x 1200w PC with barn doors mounted across the lighting bars and truss. *For more detailed information on the configuration of these lights a house plan is available upon request.*

If you feel you need more than just one colour, we can offer this by using our 10x modern full colour LED Par Cans (R, G, B & W). These are flown onsite and controlled using the lighting desk to provide individual colour choices for each unit. Alternative settings and more detailed programming of the LED Par Cans are available for an additional charge.

The current theatrical lighting infrastructure includes a Theatrelight 48 Channel Scenemaster control desk, 2 x 12-way Digital Dimmer Packs, plus the light fittings we mentioned above. The result and the basic lighting package on offer will give you

- 1 Full stage wash in combinations of open white, red, green, or blue.
- 2 Profile spots to allow a lectern or MC position to be well lit from the front left and right with key light from behind.

Managed Lighting and Sound supplied at \$200 fee + \$65 per hour:

Our in-house lighting and sound technician can be made available upon request at the rate of just \$65 per/hour. They are more than happy to point, focus and colour the lighting for you. They can also programme the lighting desk and operate the lighting during rehearsals and the show should your event require this level of detail.

Please Note:

- *Lowering of the stage fly bar winches or chain motors connected to the front truss, can only be executed by a qualified Lighting Technician with the correct rigging accreditation.*
- *Any requirements to move the stage lighting from the basic pre-set positions can only be delivered by the venue lighting technician and will be charged at \$65 per/hour.*

2.2 Audio and AV

Basic Sound Package supplied for \$100:

The in house JBL line array, sound system, is available in our basic sound package. For this cost, we provide one wired/wireless microphone on a stand, along with the speakers, amps and mixing desk that provide full coverage of the auditorium with ease.

This in-house Public-Address System is fully capable of far more than just the spoken word, as it is an absolutely state-of-the-art voice and accompanying music reproduction system, delivering true high fidelity, top of the line audio with volume and clarity that will surprise most users. However, this does have its limitations.

Please Note:

- The system is not capable for use as a full concert band system.

2.3 Sound System Details

The Behringer X 32 Digital mixing console is located in the control room and controls the entire system allowing for all the reverb, delay compression and limiting to each of the 36 input channels.

The inputs link to the desk via CAT6 Ethernet cables from the OP side of stage where a single Behringer digital snake and patch bay is located (16 inputs and 8 returns).

The amplifiers are located at the same OP side of stage directly under the multicore patch bay and have all the speaker processing, compression and limiting built into the amps themselves. The amps feed to a pair of JBL CBT701 Line Array loudspeakers which are mounted on the stage proscenium.

A single Microphone on a stand and 3.5mm mini-jack cable is provided with the base package but there are many additional add on devices available and we have listed just a few common items below.

2.4 Additional sound equipment available for hire in-house

Handheld Wireless Radio Microphones	\$65.00
Lapel Wireless Radio Microphone	\$65.00
Microphone stands (Full Size Short Boom or table style)	\$15.00
Foldback Speakers JBL Eon G3 15" & Horns with all cables provided	\$250.00
Standard Basic Lectern	\$50.00

2.5 AV Projection & Display devices

The PAC has a pair of very bright (5000 ANSI Lumen) roof mounted projectors along with fully motorised 10x6.5 ft screens on either side of the proscenium.

The cost for the two projectors and screens is \$200. There is an option to have a third projector in the foyer with a camera feed if required, for an additional **\$100.**

The input signal to these is via the CAT6 TX/RX way lines located in the Technical Control Room or we can link your PC at the side of stage.

Please note:

- There is some technical assistance required in order to achieve this.

"I-Mag" or "Image Magnification" requires both a camera and operator and will allow you to professionally record the event at the same time if you require this service. We would feed the audio directly off the sound desk giving the result similar to any Broadcast quality level recording. This will incur **the \$65 per hour** managed sound and lighting fee.

3.To Make a Booking

To arrange a site visit or if you have any enquiries regarding the Notre Dame des Missions Performing Arts Centre at Sacred Heart College, contact Vicky Thorby on the below email, or use our enquiry form on our website.

Vicky Thorby
pacadmin@sacredheartcollege.school.nz

Effective date of document: 29 May 2024